

CI Solutions for Renovation of Brick and Masonry

Senergy EIFS are a beautiful, functional solution for exteriors when you are converting older brick/unit masonry/concrete structures. Senergy Wall Systems compliments and are compatible with brick, masonry and concrete buildings.

RENOVATION OF BRICK AND MASONRY

Older buildings can experience higher energy costs compared to modern buildings that are comparable in size. The addition of continuous insulation and the retention of the brick or stone appearance can be accomplished by using Senergy Senerbrick “brick-look” or “stone look” templates. “Popped” or missing bricks are expensive to replace and matches to old bricks can be costly and difficult to locate. If the cost outweighs the value, the use of EIFS can become the most cost-effective option for addressing moisture and appearance issues.

If there are signs of moisture damage such as efflorescence, mold, discoloration, or growth of vegetation, etc., the renovation plan must include addressing the root of the problem. When the point of moisture entry is through the face of the brick or mortar joints, installation of EIFS over the wall will create a weather barrier that will eliminate surface penetration as a moisture source.

The following information describes the basic guidelines for addressing typical conditions that could be encountered prior to the installation of EIFS over brick.

BRICK IN GOOD CONDITION

In cases where the brick or masonry is generally sound and a positive adhesive bond with Senergy Adhesive Base Coat or Senergy Senershield air/water-resistive barrier can be achieved, the two most popular EIFS are the Senerflex Classic PB barrier system and Channeled Adhesive CI Design (see diagrams on page 4 and 5).

An adhesion test is always recommended when plans include the installation of EIFS over existing masonry or concrete. Sand, dust, dirt, sealers, efflorescence, environmental contaminants, and bond breakers could have negative effects upon adhesion. Prior to the adhesion test, surfaces must be cleaned. Reference the “*Basics of Conducting Field Adhesion Testing*” Technical Bulletin for more information.

SPALLING – DETERIORATED BRICK, TYPICALLY WITH MISSING MORTAR



Deteriorated masonry will generally need some level of repair prior to over cladding with EIFS. When spalling has occurred, related problems such as water damage might have already affected the interior of the wall in some way. Always consult with a structural engineer who can develop an assessment of the building that includes a thorough evaluation of any damage.

Depending upon the engineer's findings, the renovation plan could be as simple as repointing and adhering an EIFS insulation board to the existing surface or skim coating the wall. The findings might also lead to more involved planning to include build outs with an exterior sheathing, partial demolition of existing walls, construction

of new framing and/or attachment of PermaLath 1000 or metal lath. If fastening sheathing, lath or framing over an existing wall, consult with a fastener manufacturer to select an appropriate fastener for the specific application. Fastener pull-out tests should be requested to confirm the integrity of the attachment to existing walls.

Use of parge coats or levelers that are designed to fill in missing portions of individual bricks may be necessary. When selecting the filler, confirm adhesive bond compatibility with Senergy materials and follow the manufacturer's application instructions.

If you cannot adhesively attach EIFS due to failed bond testing (third party barrier, glazed or painted brick), or due to irregularity of the surface (split face or fluted block), using a system such as Senerflex Adhered Mat CI Design should be explored.

BRICK WITH EXTENSIVE EFFLORESCENCE AND/OR VEGETATIVE GROWTH



In most cases, power washing is effective in removing dust, dirt and environmental contaminants, however, use of efflorescence cleaning products may be necessary. Painted or sealed surfaces might require high-pressure power washing.

Perform an adhesion test after the power washing unless the EIFS will be mechanically attached. Consult with a knowledgeable fastener manufacturer to ensure a selection of the best fastener for your specific application. (Wind-Lock – www.wind-lock.com – provides a chart with wind load ratings of its fasteners for various combinations of EPS thicknesses and substrates.)

CRACKS IN BRICK ALONG MORTAR LINES

When mortar in older buildings contain distinct building movement crack patterns, you must determine whether the movement has stabilized so it will not affect EIFS performance. If the cracks were patched, or if sealant was used to seal the cracks, the condition of those repairs will disclose whether movement has continued. A structural engineer might be needed for a conclusive evaluation. If the wall is stable, installation of EIFS will follow procedures related to the surface of the brick.



BUILDING MOVEMENT CAUSING BRICK TO BE OUT OF PLANE

When this condition exists, a structural engineer must first evaluate whether the building is still moving, requires internal bracing, has framing damage, etc. Apply EIFS after evaluating for other significant issues, or after the issues have been addressed.

HEAVILY PAINTED BRICK

Paint may trap moisture in the brick and lead to other issues. A qualified inspector should determine if the brick and wall behind it are sound. Remove all loose, peeling or flaking paint.

Confirm bond to existing coating, use of WB Surface Stabilizer by Master Builders Solutions may promote adhesion. If a large portion of bare and sound brick is revealed, adhesive application of EPS could be possible. Confirm the bond by performing an adhesion test. Add two to four fasteners per board for assurance. If a bond cannot be achieved, explore use of Senenergy Senerflex Adhered Mat CI Design.



WITH SO MANY SYSTEMS TO PICK FROM, WHICH IS BEST FOR YOU?

- **Senerflex Channeled Adhesive CI Design** – A water managed EIFS, existing windows will be removed, and the existing surface is in the proper condition for Senergy Senershield air/water/resistive barrier and adhesive attachment.
- **Senerflex Adhered Mat CI Design** – A water managed EIFS, existing windows will be removed, conditions will allow use of Senergy Senershield air/water/resistive barrier, but the existing wall surface will not allow for adhesive attachment.
- **Senerflex Classic PB** – To simply add insulation value or aesthetic appeal, where conditions allow adhesive application.
- **Senerflex Secondary Weather Barrier Design** – To add a secondary level of protection but without drainage, where conditions allow for use of the Senergy Senershield air/water-resistive barrier and adhesive attachment.

Senerflex Classic PB

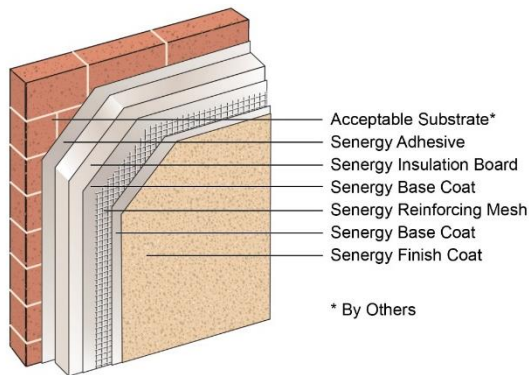

Senerflex Adhered Mat CI Design*

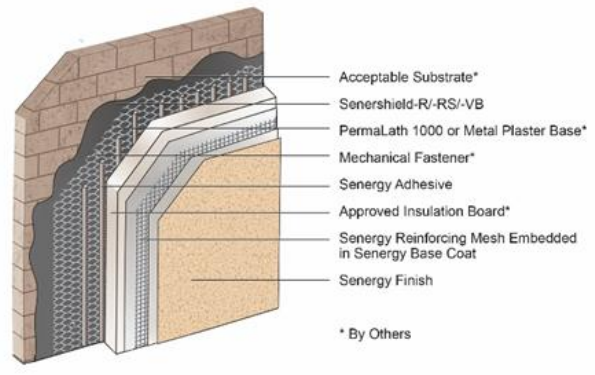

*with Senershield AWRB & Drainage

Senerflex Channeled Adhesive CI*

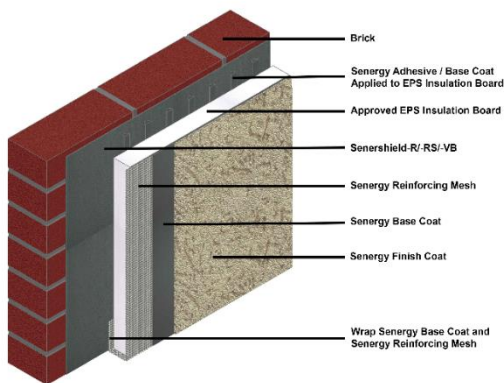

*with Drainage EIFS

Senerflex Adhered Mat CI Design*

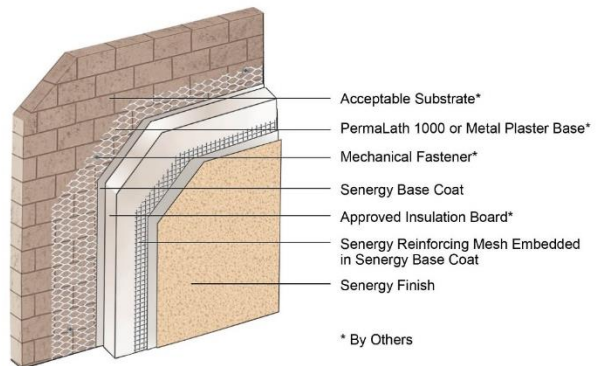

*no Drainage

LIMITED WARRANTY NOTICE: Master Builders Solutions Construction Systems US, LLC ("Master Builders") warrants this product to be free from manufacturing defects and to meet the technical properties on the current Technical Data Guide, if used as directed within shelf life. Satisfactory results depend not only on quality products but also upon many factors beyond our control. Master Builders MAKES NO OTHER WARRANTY OR GUARANTEE, EXPRESS OR IMPLIED, INCLUDING WARRANTIES OF MERCHANTABILITY OR FITNESS FOR A PARTICULAR PURPOSE WITH RESPECT TO ITS PRODUCTS. The sole and exclusive remedy of Purchaser for any claim concerning this product, including but not limited to, claims alleging breach of warranty, negligence, strict liability or otherwise, is shipment to purchaser of product equal to the amount of product that fails to meet this warranty or refund of the original purchase price of product that fails to meet this warranty at the sole option of Master Builders. Any claims concerning this product must be received in writing within one (1) year from the date of shipment and any claims not presented within that period are waived by Purchaser. Master Builders WILL NOT BE RESPONSIBLE FOR ANY SPECIAL, INCIDENTAL, CONSEQUENTIAL (INCLUDING LOST PROFITS) OR PUNITIVE DAMAGES OF ANY KIND.

Purchaser must determine the suitability of the products for the intended use and assumes all risks and liabilities in connection therewith. This information and all further technical advice are based on Master Builders present knowledge and experience. However, Master Builders assumes no liability for providing such information and advice including the extent to which such information and advice may relate to existing third-party intellectual property rights, especially patent rights, nor shall any legal relationship be created by or arise from the provision of such information and advice. Master Builders reserves the right to make any changes according to technological progress or further developments. The Purchaser of the Product(s) must test the product(s) for suitability for the intended application and purpose before proceeding with a full application of the product(s). Performance of the product described herein should be verified by testing and carried out by qualified experts.

For the most current version of this literature, please visit our website at senergy.master-builders-solutions.com/en.

Master Builders Solutions
Construction Systems US, LLC

889 Valley Park Drive, Shakopee MN 55379
senergy.master-builders-solutions.com/en

Customer Service +1 (800) 433-9517
Technical Service +1 (800) 589-1336

© MBCC Group, rev 01.10.2023

© registered trademark of a MBCC Group member in many countries of the world