

# Adhered Veneer Surfacing for Concrete and Masonry Units

## System Description

Adhered Veneer Surfacing System for Concrete and Masonry Units is a weather resistant surfacing system incorporating Finestone Finestop fluid applied air/water-resistive barrier and MaxGrip Veneer Mortar - a specially formulated high-strength setting bed mortar used to adhere natural and manufactured stone, tile, and thin brick veneer.

## Design Considerations

- Acceptable Substrates: Acceptable substrates are Concrete Masonry Units (excluding fluted block; split faced block should be assessed on project by project basis), brick and concrete walls.
- Painted and otherwise coated surfaces should be inspected and prepared as approved by Master Builders Solutions before application. Ensure substrate is free of all form releasing agents or other residue. The applicator shall verify that the proposed substrate is acceptable prior to the Finestone Adhered Veneer Surfacing System installation.
- Reference system specification for testing information.
- When used on retention wall or areas where moisture may accumulate or enter the opposite side of the wall, a waterproofing material is required on the opposite side of the wall to eliminate negative hydrostatic pressure.
- Ensure tops of walls are capped or otherwise properly protected.
- Locate joints in adhered veneer above joints in CMU or concrete substrates and where indicated by design professional.

## Uses

For exterior walls in new or retrofit commercial, institutional and residential construction such as hotels, hospitals, retail, schools, multi-family apartments and condominiums, and government facilities.

## Material Substitution

Material substitution will adversely affect system performance and will void all warranty coverage unless approved in writing by Master Builders Solutions Wall Systems.

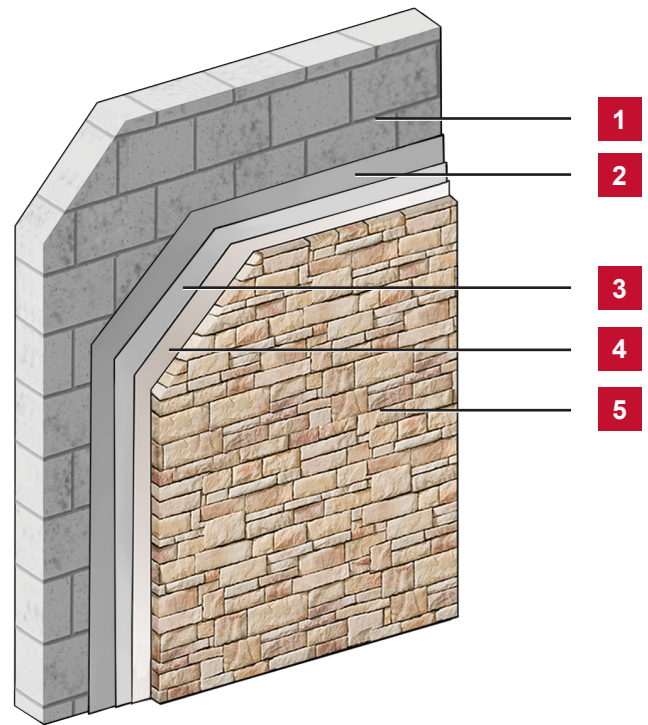

1. Acceptable Substrate\*
2. Finestop RA/RS/VB with optional MasterSeal AWB 600 FL Block Filler
3. Skim Coat of MaxGrip Veneer Mortar
4. MaxGrip Veneer Mortar
5. Adhered Veneer\*

(\*By Others)

# Adhered Veneer Surfacing for Concrete and Masonry Units

## Limitations

- Use only for above grade vertical walls. Not for use below grade or on surfaces subject to continuous or intermittent immersion in water or hydrostatic pressure.
- Per code veneer unit shall not exceed 2 5/8" (66.7 mm) in specified thickness, 36" (914 mm) in longest dimension not more than 5 ft<sup>2</sup> (0.46 m<sup>2</sup>) in total face area and shall not weigh more than 15 lbs/ft<sup>2</sup> (718 Pa).
- All products must be installed at minimum 40°F (4°C) ambient and substrate temperatures unless otherwise noted on specific Master Builders Solutions Product Bulletins.
- All products must be stored in accordance with specific instructions on relevant Master Builders Solutions Product Bulletins.
- All substrates must be clean, dry and sound without planar irregularities greater than 1/4-inch per 10-feet (6 mm per 3 m).

## Warranty Statement

Master Builders Solutions warrants this product to be free from manufacturing defects and to meet the technical properties on the current Product Bulletin, if used as directed within shelf life. Satisfactory results depend not only on quality products but also upon many factors beyond our control. MASTER BUILDERS SOLUTIONS MAKES NO OTHER WARRANTY OR GUARANTEE, EXPRESS OR IMPLIED, INCLUDING WARRANTIES OF MERCHANTABILITY OR FITNESS FOR A PARTICULAR PURPOSE WITH RESPECT TO ITS PRODUCTS. The sole and exclusive remedy of Purchaser for any claim concerning this product, including but not limited to, claims alleging breach of warranty, negligence, strict liability or otherwise, is shipment to purchaser of product equal to the amount of product that fails to meet this warranty or refund of the original purchase price of product that fails to meet this warranty, at the sole option of Master Builders Solutions. In the absence of an extended warranty issued by Master Builders Solutions, any claims concerning this product must be received in writing within one (1) year from the date of shipment and any claims not presented within that period are waived by Purchaser. MASTER BUILDERS SOLUTIONS WILL NOT BE RESPONSIBLE FOR ANY SPECIAL, INCIDENTAL, CONSEQUENTIAL (INCLUDING LOST PROFITS) OR PUNITIVE DAMAGES OF ANY KIND.

Purchaser must determine the suitability of the products for the intended use and assumes all risks and liabilities in connection therewith. This information and all further technical advice are based on Master Builders Solutions present knowledge and experience. However, Master Builders Solutions assumes no liability for providing such information and advice including the extent to which such information and advice may relate to existing third party intellectual property rights, especially patent rights, nor shall any legal relationship be created by or arise from the provision of such information and advice. Master Builders Solutions reserves the right to make any changes according to technological progress or further developments. The Purchaser of the Product(s) must test the product(s) for suitability for the intended application and purpose before proceeding with a full application of the product(s). Performance of the product described herein should be verified by testing and carried out by qualified experts.