





MasterTop WS 200 PU

Elastic polyurethane wall system, smooth, low emission, matt finish

Fields of application: industrial areas, indoor system, bearing medium to heavy im-pacts where required: for example production areas, warehouses and technology rooms, etc.

Consumption:

	Primer*	MasterTop primer range Please refer to the primer matrix	0,10-0,25 kg/m ² per layer
	Body coat (1st layer)	MasterTop BC 328 FLR 2K-PU body coat, fire retardant, solvent free, low emission	0,8-1,2 kg/m ² per layer
	Body coat (2nd layer)	MasterTop BC 328 FLR 2K-PU body coat, fire retardant, solvent free, low emission	0,4-0,5 kg/m ² per layer
	Top coat** for light and bright colours at least two layers are mandatory	MasterTop TC 427W 2K-PU colored (white) top coat, water borne, solvent free elastic, UV-stable, matt, low emission	0,04-0,06 kg/m ² per layer
		or (if other colors than white are desired)	
		MasterTop TC 417W 2K-PU colored top coat, water borne, non solvented, elastic, UV-stable, matt, bacterio- static, low emission	0,04-0,06 kg/m ² per layer
		or	
		MasterTop TC 442W 2K-PU colored top coat, water borne, solvent free, semi-rigid, UV-stable, matt, low emission	0,05-0,07 kg/m ² per layer
	Total thickness of the system	1,0-1,5 mm	

Remark: Consumptions are indicative and may be higher, depending on substrate roughness, temperature and porosity, as well as waste produced during application.
 MasterTop WS 200 PU can be applied over gypsum wallboard, cement and gypsum plasters, concrete, concrete block and cement based mortars, with a maximum humidity content of 4%.

* Recommended primers: MasterTop P 615, MasterTop P 622, MasterTop P 686W
 MasterTop P 615 - EP, 2-component, solvent free (total solid)
 MasterTop P 622 - EP, 2-component, solvent free (total solid)
 MasterTop P 686W - EP, 2-component, water-based
 Consumptions are indicative and may be higher, depending on substrate roughness, temperature and porosity, as well as waste produced during application.

**** Tested at EN 23270 ambient conditions

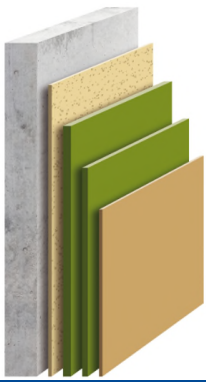

MasterTop WS 200 PU

Elastic polyurethane wall system, smooth, low emission, matt finish

In order to use the suitable primer, please refer to the following primer matrix:

Primer	Concrete	Gypsum wallboard	Concrete Blocks	Cement based mortars	Gypsum plasters
MasterTop P 622	x		x	x	
MasterTop P 615	x		x	x	
MasterTop P 686W	x	x	x	x	x

** If a bacteriostatic effect is required then only MasterTop TC 417W can be applied.

The wall system fulfills, as minimum requirements, the following properties and technical data determined by internal and external testing:

Emissions behavior

AgBB conform,
AFSSET conform,
A+ Classification

Crack bridging
(23 °C)

Class A 3 according to DIN EN 1062-7
required > 500 µm, achieved = 650 µm

Fire behavior according to
DIN EN 13501-1

Cs1-d0

DISCLAIMER

The technical information given in this publication is based on the present state of our best scientific and practical knowledge. Master Builders Solutions Yapı Kimyasalları Sanayi ve Ticaret Ltd. Şti. is only responsible for the quality of the product. Master Builders Solutions Yapı Kimyasalları Sanayi ve Ticaret Ltd. Şti. is not responsible for results that may occur because the product is used other than advised and/or out of instructions regarding the place and the method of use. This technical form is valid only till a new version is implemented and nullifies the old ones.

CONTACT INFORMATION

Master Builders Solutions Yapı Kimyasalları
Sanayi ve Ticaret Ltd. Şti.
Adres: Barbaros Mah. Begonya Sok.
Nidakule Kuzey Ataşehir, C Kapısı
No:3 E/5, 34746 Ataşehir İstanbul / Türkiye
Tel: 0216 217 88 00
Mail: mbs.tr@mbcc-group.com
Web: www.master-builders-solutions.com/tr-tr

® Registered trademark of a MBCC Group member in many countries of the world