

# MasterSeal<sup>®</sup> NP 150

## Typical Details for Framed and Masonry/Concrete Construction Incorporating MasterSeal NP 150 as a Liquid Flashing Membrane

### TABLE OF CONTENTS

1. Typical Rough Opening Treatment with MasterSeal NP 150 on Masonry or Concrete Construction without Buck
2. Typical Rough Opening Treatment with MasterSeal NP 150 on Framed Construction without Buck
3. Typical Rough Opening Treatment with MasterSeal NP 150 on Masonry or Concrete Construction with Flushed Buck
4. Typical Rough Opening Treatment with MasterSeal NP 150 on Framed Construction with Flushed Buck
5. Typical Rough Opening Treatment with MasterSeal NP 150 on Masonry or Concrete Construction with a Recessed Buck
6. Typical Rough Opening Treatment with MasterSeal NP 150 on Framed Construction with a Recessed Buck
7. Typical Rough Opening Treatment with MasterSeal NP 150 on Masonry or Concrete Construction with a Protruding Buck
8. Typical Rough Opening Treatment with MasterSeal NP 150 on Framed Construction with a Protruding Buck

## MasterSeal NP 150 as a Liquid Flashing Membrane

TYPICAL ROUGH OPENING TREATMENT WITH NP 150  
ON MASONRY OR CONCRETE CONSTRUCTION WITHOUT BUCK

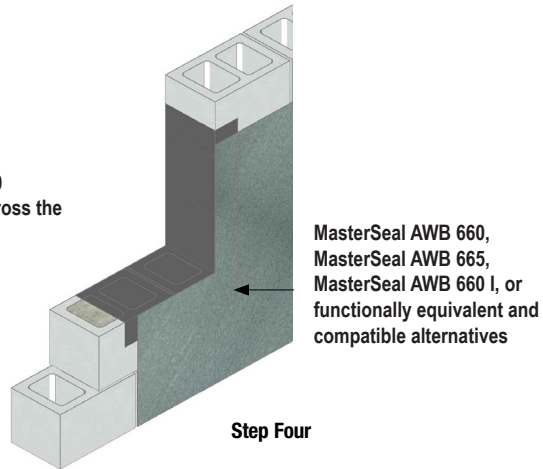
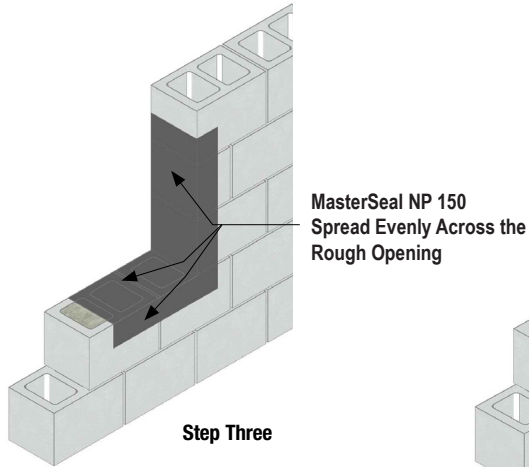
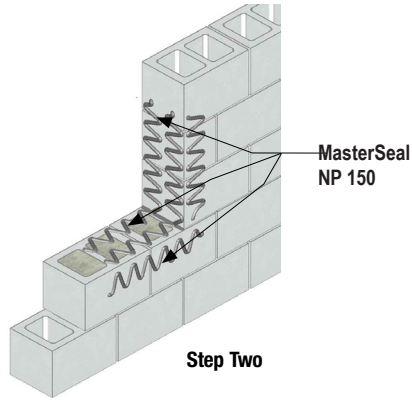
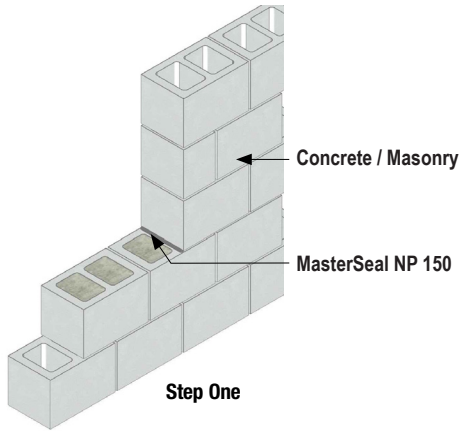

- Ensure that MasterSeal NP 150 is uniformly applied at a 20 mil thickness.
- Extend MasterSeal NP 150 at least 100 mm (4") onto the exterior wall, maintaining 20 mil thickness.
- Allow MasterSeal NP 150 to skin before applying fluid-applied air/water resistive barrier.
- Lap air/water-resistive barrier at least 50 mm (2") onto MasterSeal NP 150, creating a continuous, monolithic air/water resistive barrier

## MasterSeal NP 150 as a Liquid Flashing Membrane

TYPICAL ROUGH OPENING TREATMENT WITH MASTERSEAL NP 150  
ON FRAMED CONSTRUCTION WITHOUT BUCK

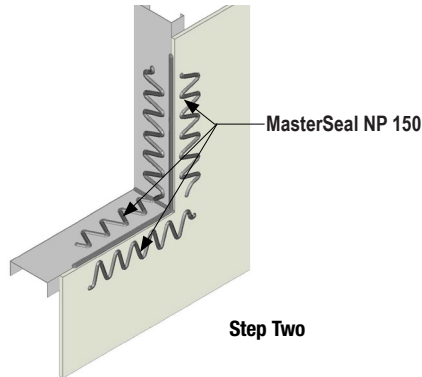
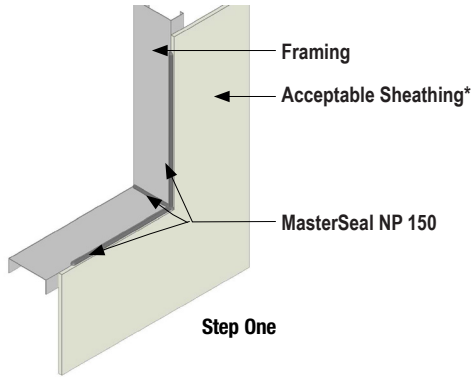

- Ensure that MasterSeal NP 150 is uniformly applied at a 20 mil thickness.
- Extend MasterSeal NP 150 at least 100 mm (4") onto the exterior wall, maintaining 20 mil thickness.
- Allow MasterSeal NP 150 to skin before applying fluid-applied air/water resistive barrier.
- Lap air/water-resistive barrier at least 50 mm (2") onto MasterSeal NP 150, creating a continuous, monolithic air/water resistive barrier

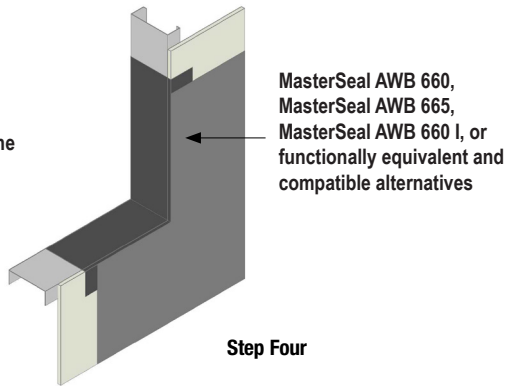
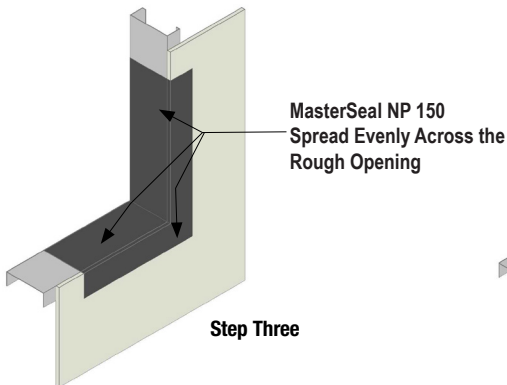

## MasterSeal NP 150 as a Liquid Flashing Membrane

TYPICAL ROUGH OPENING TREATMENT WITH MASTERSEAL NP 150 ON  
MASONRY CONSTRUCTION WITH FLUSHED BUCK

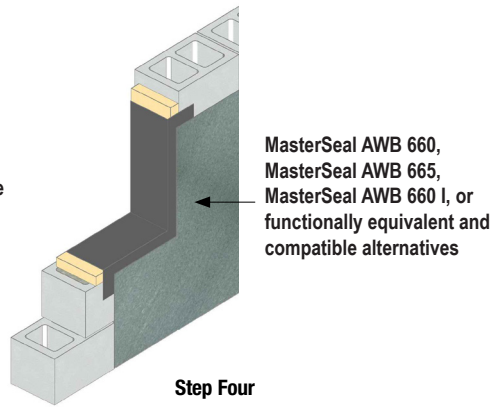
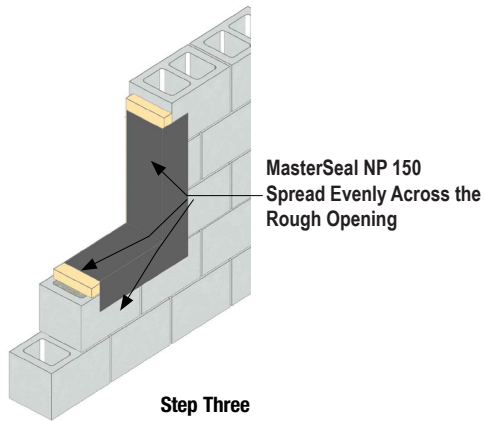
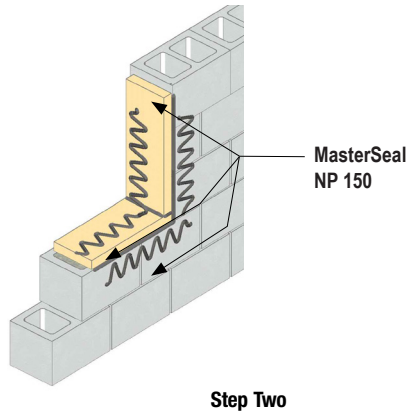
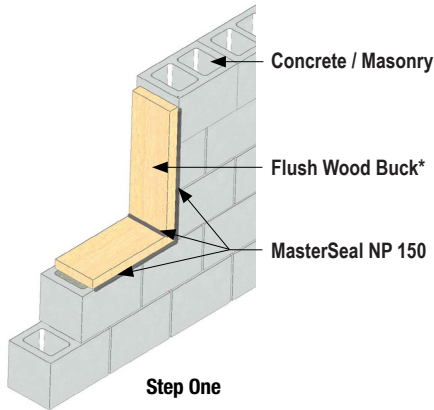

- Ensure that MasterSeal NP 150 is uniformly applied at a 20 mil thickness.
- Extend MasterSeal NP 150 at least 100 mm (4") onto the exterior wall, maintaining 20 mil thickness.
- Allow MasterSeal NP 150 to skin before applying fluid-applied air/water resistive barrier.
- Lap air/water-resistive barrier at least 50 mm (2") onto MasterSeal NP 150, creating a continuous, monolithic air/water resistive barrier

## MasterSeal NP 150 as a Liquid Flashing Membrane

TYPICAL ROUGH OPENING TREATMENT WITH MASTERSEAL NP 150  
ON FRAMED CONSTRUCTION WITH FLUSH BUCK

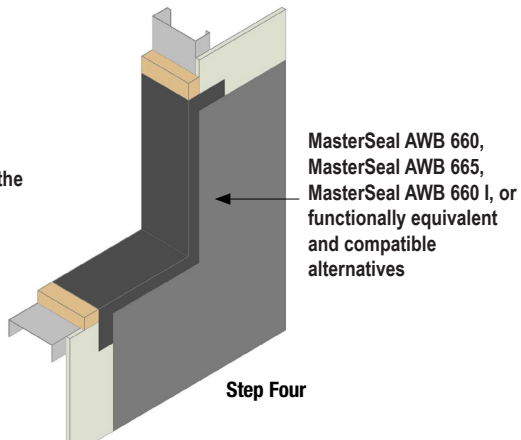
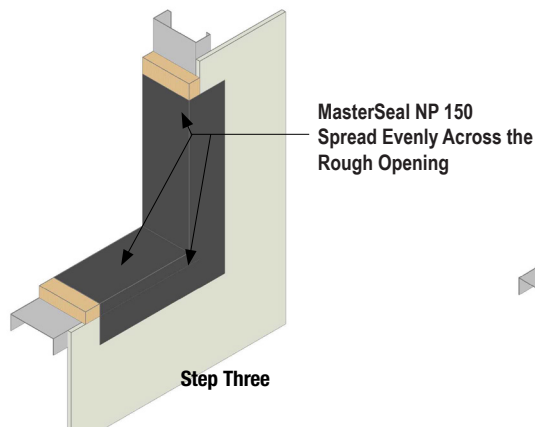
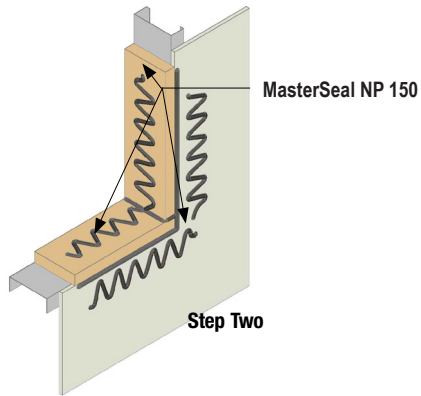
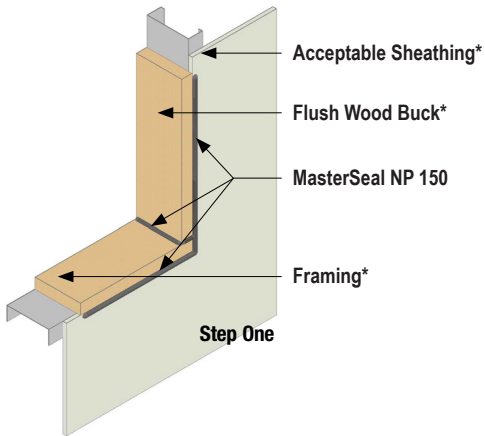

- Ensure that MasterSeal NP 150 is uniformly applied at a 20 mil thickness.
- Extend MasterSeal NP 150 at least 100 mm (4") onto the exterior wall, maintaining 20 mil thickness.
- Allow MasterSeal NP 150 to skin before applying fluid-applied air/water resistive barrier.
- Lap air/water-resistive barrier at least 50 mm (2") onto MasterSeal NP 150, creating a continuous, monolithic air/water resistive barrier

## MasterSeal NP 150 as a Liquid Flashing Membrane

TYPICAL ROUGH OPENING TREATMENT WITH MASTERSEAL NP 150 ON  
MASONRY OR CONCRETE CONSTRUCTION WITH A RECESSED BUCK

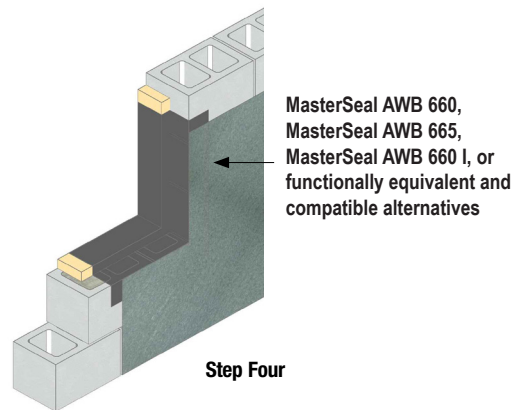
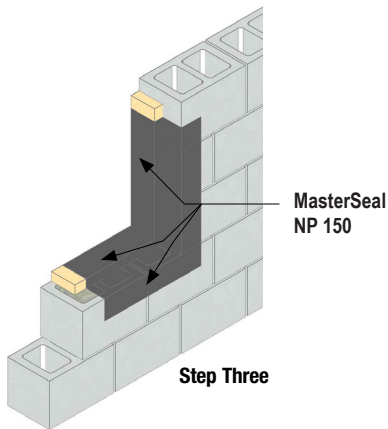
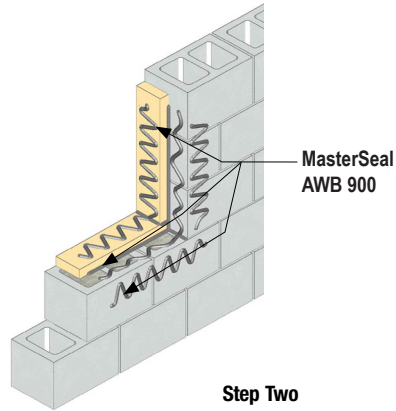
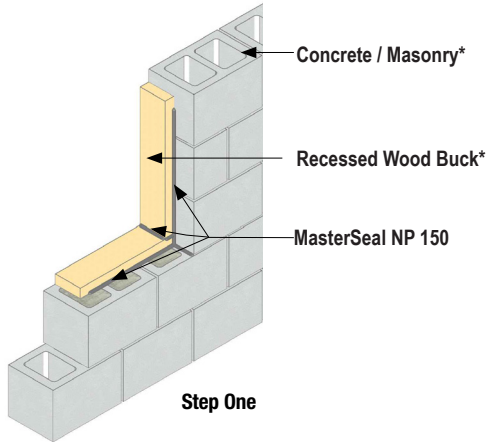

- Ensure that MasterSeal NP 150 is uniformly applied at a 20 mil thickness.
- Extend MasterSeal NP 150 at least 100 mm (4") onto the exterior wall, maintaining 20 mil thickness.
- Allow MasterSeal NP 150 to skin before applying fluid-applied air/water resistive barrier.
- Lap air/water-resistive barrier at least 50 mm (2") onto MasterSeal NP 150, creating a continuous, monolithic air/water resistive barrier

## MasterSeal NP 150 as a Liquid Flashing Membrane

TYPICAL ROUGH OPENING TREATMENT WITH MASTERSEAL NP 150  
ON FRAMED CONSTRUCTION WITH A RECESSED BUCK

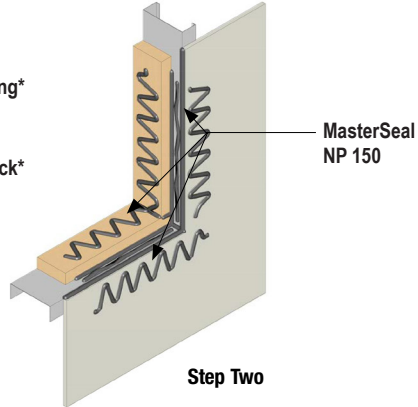
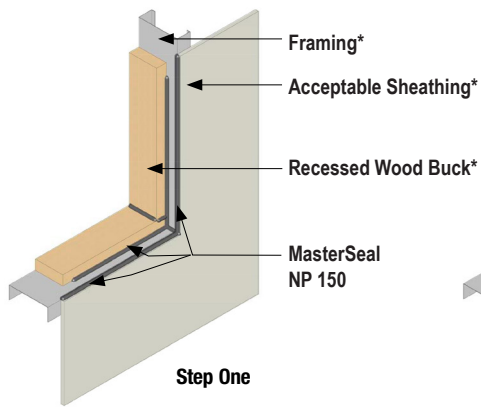

- Ensure that MasterSeal NP 150 is uniformly applied at a 20 mil thickness.
- Extend MasterSeal NP 150 at least 100 mm (4") onto the exterior wall, maintaining 20 mil thickness.
- Allow MasterSeal NP 150 to skin before applying fluid-applied air/water resistive barrier.
- Lap air/water-resistive barrier at least 50 mm (2") onto MasterSeal NP 150, creating a continuous, monolithic air/water resistive barrier

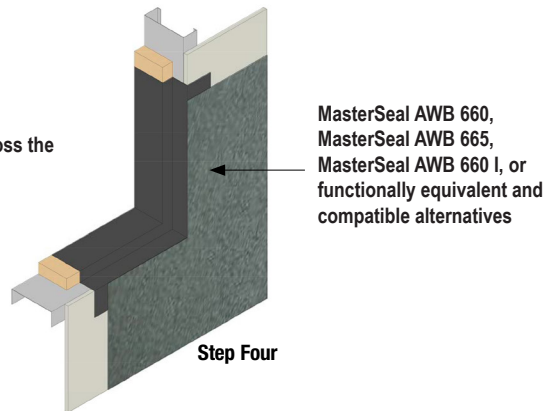
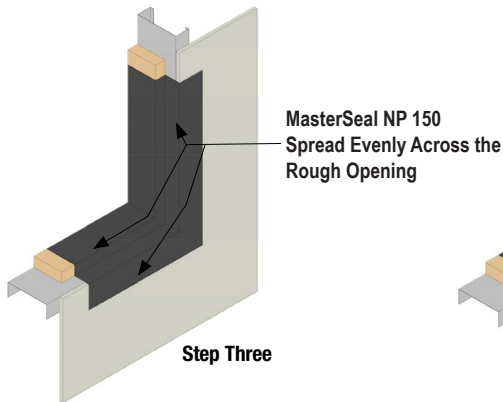

## MasterSeal NP 150 as a Liquid Flashing Membrane

TYPICAL ROUGH OPENING TREATMENT WITH MASTERSEAL NP 150 ON MASONRY OR CONCRETE CONSTRUCTION WITH A PROTRUDING BUCK

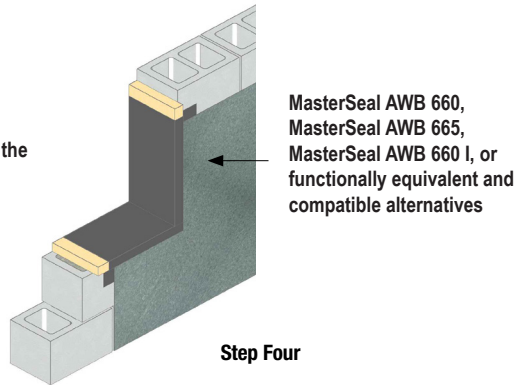
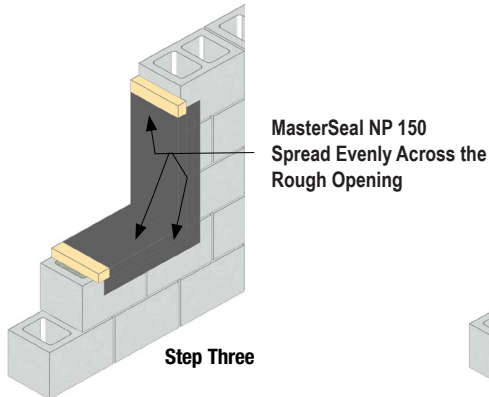
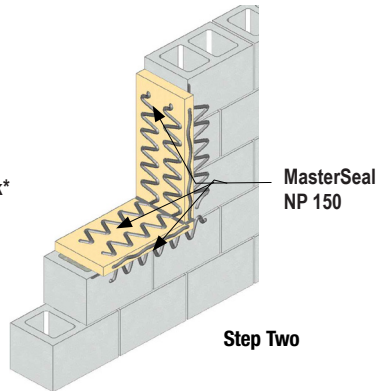
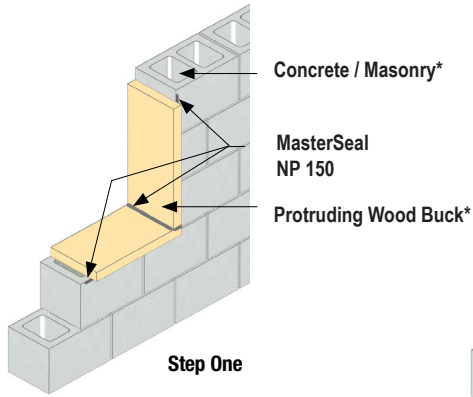

- Ensure that MasterSeal NP 150 is uniformly applied at a 20 mil thickness.
- Extend MasterSeal NP 150 at least 100 mm (4") onto the exterior wall, maintaining 20 mil thickness.
- Allow MasterSeal NP 150 to skin before applying fluid-applied air/water resistive barrier.
- Lap air/water-resistive barrier at least 50 mm (2") onto MasterSeal NP 150, creating a continuous, monolithic air/water resistive barrier



## MasterSeal NP 150 as a Liquid Flashing Membrane

TYPICAL ROUGH OPENING TREATMENT WITH MASTERSEAL NP 150  
ON FRAMED CONSTRUCTION WITH A PROTRUDING BUCK

- Ensure that MasterSeal NP 150 is uniformly applied at a 20 mil thickness.
- Extend MasterSeal NP 150 at least 100 mm (4") onto the exterior wall, maintaining 20 mil thickness.
- Allow MasterSeal NP 150 to skin before applying fluid-applied air/water resistive barrier.
- Lap air/water-resistive barrier at least 50 mm (2") onto MasterSeal NP 150, creating a continuous, monolithic air/water resistive barrier

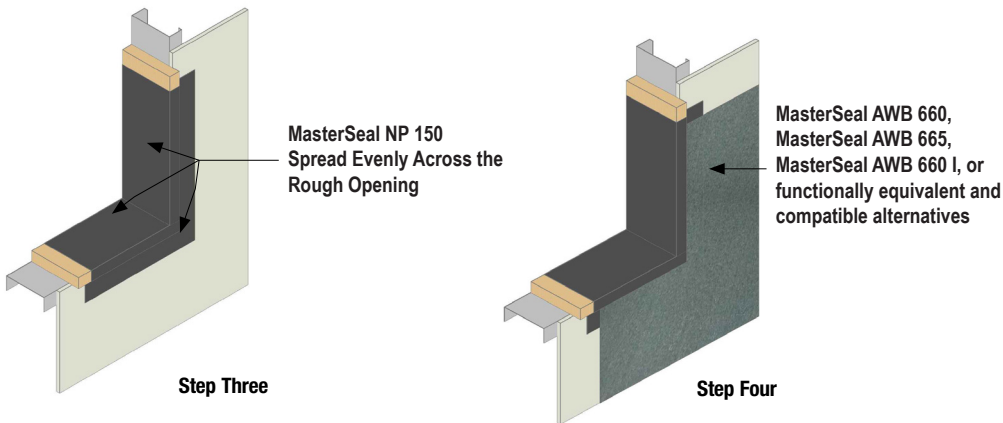
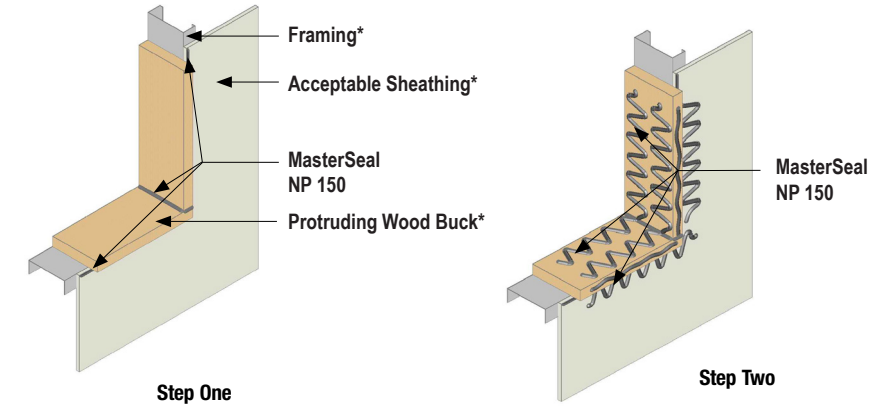

---

#### HEALTH , SAFETY AND ENVIRONMENTAL

Read, understand and follow all Safety Data Sheets and product label information for this product prior to use. The SDS can be obtained by visiting [mbcc.sika.com/en-us](http://mbcc.sika.com/en-us), e-mailing your request to [mbsbscst@mbcc-group.com](mailto:mbsbscst@mbcc-group.com) or calling 1(800) 433-9517.

Use only as directed.

IN CASE OF EMERGENCY: Call CHEMTEL

+1 (800) 255-3924 or if outside the US or Canada,  
+1 (813) 248-0585.

---

#### LIMITED WARRANTY NOTICE

Master Builders Solutions Construction Systems US, LLC ("Master Builders") warrants this product to be free from manufacturing defects and to meet the technical properties on the current Technical Data Guide, if used as directed within shelf life. Satisfactory results depend not only on quality products but also upon many factors beyond our control. MASTER BUILDERS MAKES NO OTHER WARRANTY OR GUARANTEE, EXPRESS OR IMPLIED, INCLUDING WARRANTIES OF MERCHANTABILITY OR FITNESS FOR A PARTICULAR PURPOSE WITH RESPECT TO ITS PRODUCTS. The sole and exclusive remedy of Purchaser for any claim concerning this product, including but not limited to, claims alleging breach of warranty, negligence, strict liability or otherwise, is shipment to purchaser of product equal to the amount of product that fails to meet this warranty or refund of the original purchase price of product that fails to meet this warranty, at the sole option of Master Builders. Any claims concerning this product must be received in writing within one (1) year from the date of shipment and any claims not presented within that period are waived by Purchaser. MASTER BUILDERS WILL NOT BE RESPONSIBLE FOR ANY SPECIAL, INCIDENTAL, CONSEQUENTIAL (INCLUDING LOST PROFITS) OR PUNITIVE DAMAGES OF ANY KIND.

Purchaser must determine the suitability of the products for the intended use and assumes all risks and liabilities in connection therewith. This information and all further technical advice are based on Master Builders' present knowledge and experience. However, Master Builders assumes no liability for providing such information and advice including the extent to which such information and advice may relate to existing third party intellectual property rights, especially patent rights, nor shall any legal relationship be created by or arise from the provision of such information and advice. Master Builders reserves the right to make any changes according to technological progress or further developments. The Purchaser of the Product(s) must test the product(s) for suitability for the intended application and purpose before proceeding with a full application of the product(s). Performance of the product described herein should be verified by testing and carried out by qualified experts.

**FOR PROFESSIONAL USE ONLY. NOT FOR SALE TO OR USE BY THE GENERAL PUBLIC.**